

Table of Contents

- | [Welcome](#)
- | [Property Details](#)
- | [Property Video](#)
- | [Documents & Useful Links](#)
- | [Thinking of Selling?](#)
- | [Meet Your Team](#)

Welcome

Thank you for your interest in **31 Lakeside Drive, Lake Tyers Beach.**

Purchasing residential real estate can be a very exciting process, however it can also be confusing time for the prospective buyer. This eBook has been prepared to supply you with as much information as possible to help with your buying decision.

We look forward to assisting you with your housing needs.

With Thanks

First National King & Heath Sales Team

Property Details



31 Lakeside Drive, Lake Tyers Beach

BEACH SIDE DUAL LIVING

3  2  4  **\$545,000**

2 Living Areas

Air Conditioning

Shed

4 Open Spaces

Built In Robes

Area Views

Close to Schools

Close to Transport

Heating

Ocean Views

Water Views

This charming beach house in Lake Tyers Beach offers the ideal coastal escape, just a short stroll from the water. Perfectly positioned, this property is designed for flexibility and relaxation, featuring two fully self-contained levels-ideal for family getaways, rental potential, or enjoying your own private retreat.

Downstairs, you'll find a spacious one-bedroom, with its own kitchen, bathroom, and living area, offering complete independence. This level is perfect for guests, extended family, or even as a rental income opportunity.

Upstairs, the main living area features two additional bedrooms, also fully self-contained with its own kitchen, bathroom, and living space. The open-plan design flows effortlessly onto a deck, where you can relax and soak up the beachside atmosphere.

Whether you're looking for a holiday home, an investment property, or a peaceful beach retreat, this versatile property has it all. Located just a short walk from the pristine shores of Lake Tyers Beach, you can enjoy the best of coastal living, with fishing, swimming, and beach walks right on your doorstep.

Don't miss the chance to secure this perfect beach house. Contact us today to arrange a

viewing!

[Statement of Information](#)



Floor Plan

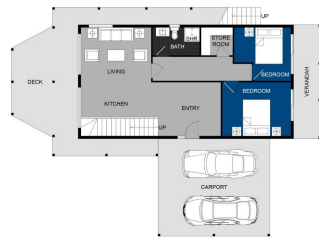

GROUND FLOOR PLAN



FIRST FLOOR PLAN

This floor plan including fixtures, finish measurements and dimensions are approximate and for illustrative purposes only.
 First National Real Estate plans to provide, where it is representative of the property and layout.
 All enquiries must be directed to the agent, vendor or party representing the floor plan.

31 Lakeside Drive, Lake Tyers Beach

Property Video

Documents & Useful Links

Additional important information that might interest you...

[Section 32](#)

[Email Us](#)

Thinking of Selling?

[Book an appraisal](#)

Take the guesswork out of selling.

With one of the largest and most detailed databases in East Gippsland, we're able to identify and engage with relevant buyers for your property from the moment you list with us.

We use the Smart Sale method to identify and connect with buyers already on our database before your property even hits the net!

Our process means that many property sales are made without going to the major real estate websites, saving your property's digital footprint.

Don't just take our word for it, read our reviews here...



Meet Your Team



JUDY VELLA

SALES

0400 505 836

judy.vella@kingheath.com.au

Judy made a bold decision to embark on a sea change from Melbourne to Lake Tyers Beach in 2010, embracing the captivating lifestyle of East Gippsland. With a strong retail background, she excels in the real estate industry, utilizing her exceptional communication skills. Judy is commended for her high level of customer service and is beloved for her warm and welcoming nature.

In her free time, she enjoys exploring the stunning locations of East Gippsland while balancing the joys of raising her children. Judy's unwavering commitment to excellence, coupled with her genuine passion for people and her beloved community, make her an invaluable asset to the King & Heath real estate team.



KELLY DOUGLASS

SALES

0400239076

kelly.douglass@kingheath.com.au

Kelly joins the King & Heath team in our Lakes Entrance office as Sales Representative, after having run her own business for 8 years. With her welcoming personality and keen attention to detail, Kelly is a valuable addition to the team. Her exceptional organisational skills and attention to details help ensure the office operations are always running smoothly.

In her free time, Kelly enjoys spending quality time with family and friends. She is well known for her friendly and helpful nature, and lives by the mantra "do your best in everything you do in life". Kelly's core values focus on treating others as she would like to be treated, a principle she upholds in both her professional and personal life.



RACHEL MARTIN

BUSINESS DEVELOPMENT/PARTNER

rachel.martin@kingheath.com.au

With an exceptional eye for Real Estate, Rachel continues her career in her hometown after many years' experience at a busy Melbourne agency. Her experience in the industry has gained her an extensive knowledge of the Residential Tenancies Act and a desire to exceed expectations. With her friendly, approachable nature, Rachel prides herself on ensuring her clients have a stress free experience when it comes to property investing. Rachel keeps herself busy with her partner and two young boys, spending a lot of their time in and around the Gippsland Lakes